

Please refer to 3D CAD files for more information

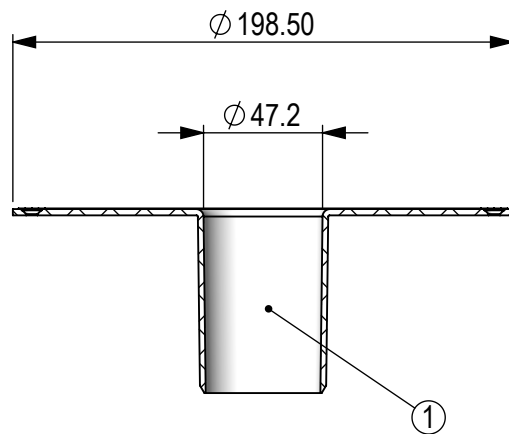

SECTION A-A

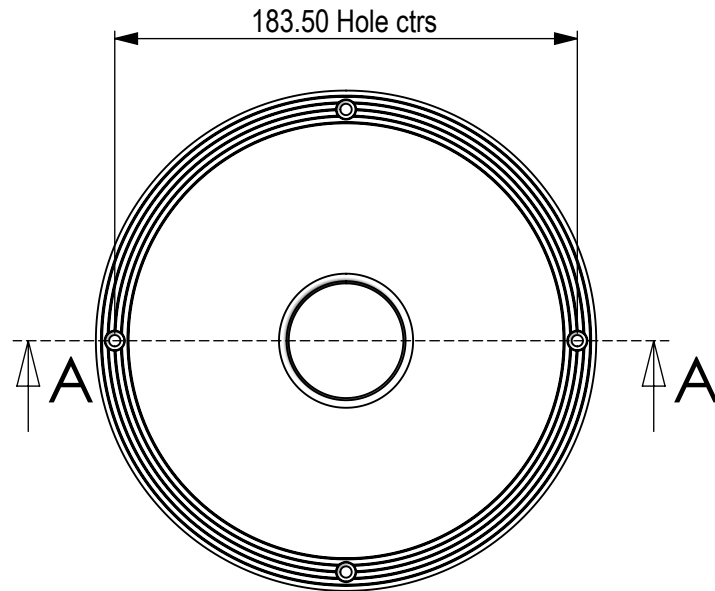
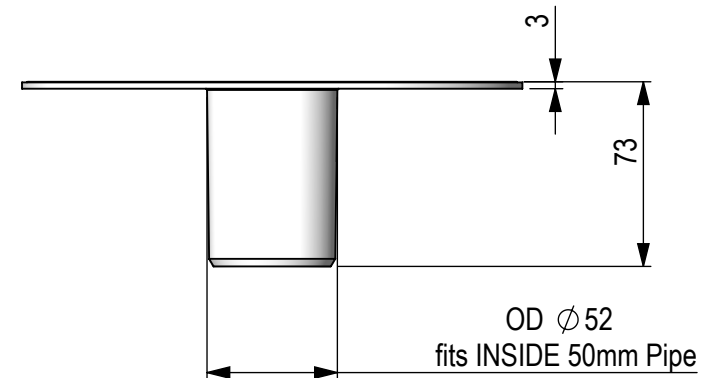
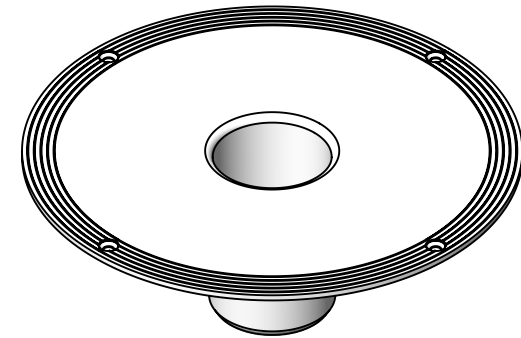

# BILL OF MATERIALS

Item no.	Material	Grams
1	ABS Plastic	98.33

THIS DRAWING IS THE PROPERTY OF "THE WONDERCAP CO." IT IS PRIVATE AND CONFIDENTIAL AND IS SUPPLIED ON THE EXPRESS UNDERSTANDING THAT IT IS NOT TO BE USED FOR ANY PURPOSE OR COPIED OR COMMUNICATED TO ANY OTHER PERSON WITHOUT THE WRITTEN PERMISSION OF "THE WONDERCAP CO."

**3Di**  
DESIGN

Gold Coast - Australia  
Ph: (07) 5575 9965  
Mob: 0414 321 237

MATERIAL: ABS Plastic

FINISH: SPI-B1

SCALE: 1:3

DRAWN: A.Rodd

DO NOT SCALE DRAWING

**1** CRITICAL DIMENSION

**1** MAJOR DIMENSION

**A** MINOR DIMENSION

GENERAL  
TOLERANCES:  
(unless stated)  
0-1mm ±0.05  
1.05-10mm ±0.1  
10.1-100mm ±0.5  
>100.5mm ± 1.0

CHECKED:

DATE: 1/09/2015

ALL DIMEN'S IN mm

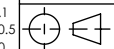

A4

**The Wondercap Company**

PO Box 130 Ashmore City Ph: 61 7 5539 3665  
CLIENT: QLD Australia 4214 info@wondercap.biz

**wc50rf**

PROJECT DRAWING NO. DESCRIPTION VERSION